



Westflex SMD, Covemax, and Covemax X Wiring Instructions

When wiring the Westflex White Light family of products there are certain important things to remember. These products are 12VDC and as such you must take into account the DC+ and DC- Polarity. The products are field cuttable every 2” and at each cut point (denoted by a dashed line) there are solder pads. Each of these solder pads is labeled +12V-, so the (+) side is positive and the (-) side is negative. You can either solder leads onto these pads to home run to your 12VDC power supply, or we can also provide a clip on lead. When soldering your leads the rule of low voltage states that a Red wire should be used for (+) and a Black wire should be used for (-). If you use our clip on leads the same rule applies.

Do not inverse polarity! The LED’s will light for a while and then you will start to lose sections on a board. There are 3 LED’s per 2” cuttable length and you will start to see them drop out.. When you get your home run leads back to the 12VDC Power Supply you will need to keep this polarity.

This figure shows the correct way of hooking up the clip on lead.

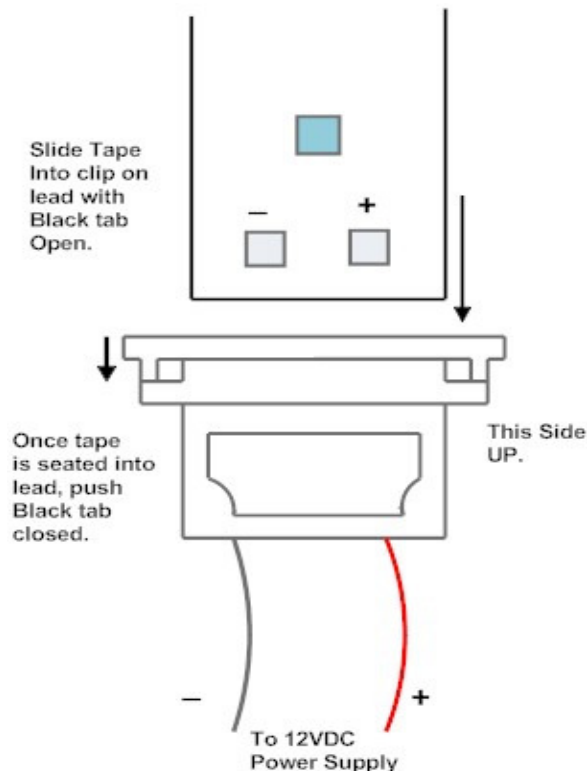

Any questions call 914-698-1141